

# Important Information

## Care and maintenance

1. Keep the unit clean by wiping it with a slightly damp cloth.
2. Keep the unit out of direct sunlight and away from any direct heat source.
3. Remove the batteries when the unit will not be in use for an extended period of time.
4. Do not drop the unit on hard surfaces.

## Troubleshooting

If for some reason the program/activity stops working or malfunctions, please follow these steps:

1. Please turn the unit OFF.
2. Interrupt the power supply by removing the batteries.
3. Let the unit stand for a few minutes, then replace the batteries.
4. Turn the unit ON. The unit should now be ready to play again.
5. If the product still does not work, replace with an entire set of new batteries.

This product complies with the essential requirements of the European Toy Safety Directive.



Trends UK LTD, Greatworth Hall,  
Banbury, OX17 2DH. UK  
Email: trends@jgdirect.net

 **Customer Services:**  
**+44 (0)1702208175**

Item Number: **PP11**

For more fun learning toys go to [www.trendsuk.co.uk](http://www.trendsuk.co.uk)



# Count with Peppa Instruction Manual



## Contents:

- Peppa and 10 coins
- Manual

## WARNING!

All packing materials such as internal bags, plastic collars, plastic films, carton inserts are not part of this product and should be discarded for your child's safety.

The batteries included in this toy are for instore demonstration purpose only.

## Important information

- This toy is suitable for children aged 2 years and over.
- Please retain this manual for further reference.
- Check unit regularly and discard if any part is damaged or broken.



OfficialPeppaPig [www.peppapig.com](http://www.peppapig.com)

Peppa Pig © Astley Baker Davies Ltd/Entertainment One UK Ltd 2003.

# Learn with Peppa.

Learn about numbers, counting, colours and shapes with Peppa. Put the colourful coins in Peppa's purse and listen as she recognises each coin!

## Product features

### 1. ON/OFF/VOLUME CONTROL SWITCH (on the back of Peppa).

The product is supplied in TryMe Mode.

To turn the unit **ON**, slide the

**ON/OFF/VOLUME CONTROL SWITCH** to the **LOW VOLUME**  or **HIGH VOLUME**  position.

To turn the unit **OFF**, slide the **ON/OFF/VOLUME CONTROL SWITCH** to the **OFF**  position.

### 2. MODE SELECTOR SWITCH (on side of Peppa).

Slide the **MODE SELECTOR SWITCH** from the **NUMBERS MODE** to the **COLOURS MODE** position to choose a mode of play.

### 3. AUTOMATIC SHUT-OFF.

To preserve battery life, Peppa will automatically power-down after approximately 45 seconds without input. The unit can be turned on again by pressing any button.

## How to Play

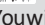
1. Slide the **ON/OFF/VOLUME CONTROL SWITCH** to **LOW VOLUME**  or **HIGH VOLUME**  to turn the unit on. You will hear Peppa ask you to learn together and insert a coin into the yellow opening in her purse.

2. Slide the selector button on the side of Peppa to learn about Counting and Numbers, or Colours and Objects.

The coins will fall into Peppa's purse, simply pull open the front of her purse to retrieve the coins. Leave the purse open when playing to make access to the coins easier.

3. In **NUMBERS MODE** Insert one of the colourful coins into Peppa's purse to hear her count.
4. In **NUMBERS MODE**, press the left hand button on her purse, Peppa will ask for a certain number of coins to be inserted into her purse. Insert the number requested in the slot in her purse to answer the question.

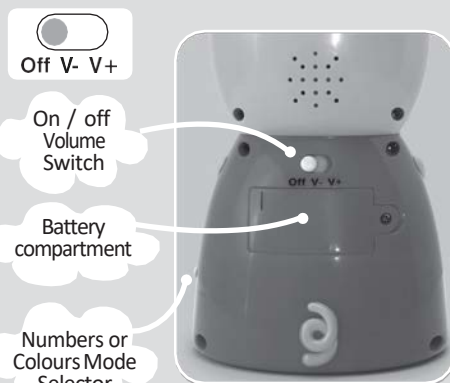

5. In **NUMBERS MODE**, press the left hand button on her purse to change the questions, Peppa will ask you to find a number eg. "Can you find the number 2?" insert the coin with the number 2 on it into the slot in her purse to answer the question.
6. In **NUMBERS MODE**, press the left hand button on her purse to change the questions, Peppa will ask you to find a number of objects eg. "Can you find a coin with 4 dinosaurs?" insert the appropriate coin into the slot in her purse to answer the question.

You will hear encouraging phrases and if you make a mistake Peppa will ask a new question.

7. In **COLOURS MODE**, press the left hand button on her purse to change the questions. Peppa will ask you find a coin with colourful objects e.g. "Can you find a coin with 7 purple flowers on it?" push the appropriate coin into her purse to answer the question.
8. In **COLOURS MODE**, press the left hand button on her purse to change the questions, Peppa will ask you find a coloured coin eg. "Can you find a blue coin?" push an appropriate coin into her purse to answer the question.

You will hear encouraging phrases and if you make a mistake Peppa will ask a new question.

9. Press right hand button on Peppa's purse to hear Peppa singing a choice of 3 songs.

## How to change batteries

1. This product requires 2 x AA 1.5v batteries.
2. The batteries supplied with the product are for store demonstration purposes only and we recommend that they are replaced after purchase.
3. Use a suitable screwdriver to remove the battery cover located on the rear of the unit.
4. Remove the old batteries. Insert 2 x AA batteries, ensuring the + and - terminals match the markings on the inside of the compartment.
5. Fit the battery compartment cover and tighten the screw to secure (but do not over-tighten).

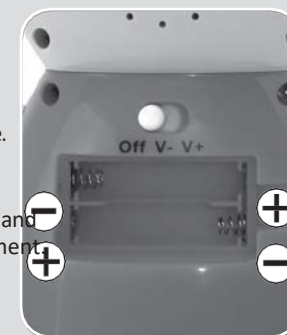

## Important battery information

Batteries must be inserted or removed by an adult.

Do not mix battery types (for example, alkaline and zinc carbon), or old and new batteries.

Do not attempt to recharge non-rechargeable batteries, as they may leak or explode.

Batteries must be inserted with the correct polarity.

Do not short circuit the supply terminals.

Remove exhausted batteries from the toy.

Remove rechargeable batteries from the toy before charging.

Rechargeable batteries must be charged by an adult.

Use only the recommended battery type or their equivalent.

Do not dispose of batteries in fire, as they may leak or explode.

Remove batteries from the toy if it is not being used for an extended period of time.



The purpose of the crossed-out wheellie bin symbol is to remind us that most electrical product and batteries contain trace elements which could be harmful to our environment and therefore our health. We must all be careful to dispose of them responsibly in a specifically designated way – either using a collection scheme or into the correctly labelled civic amenity (NOT into general waste) – this will help your local authority to arrange to recycle or dispose of them in the appropriate manner.

